

	A	B	C	D	E	SERIES 1 PANCAKE DRILL	
INCH	.250	1.042	2.027	.900	5.774	MAXIMUM RECOMMENDED DRILL DIAMETER	.1875
MM	6.35	26.46	51.48	22.86	146.6		4.76 mm

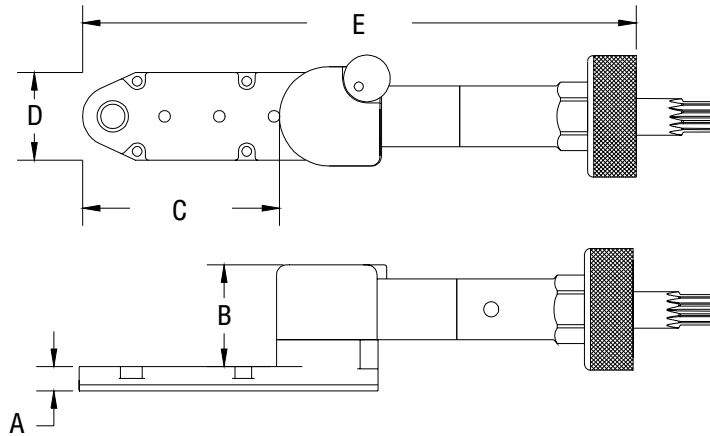

ALL BEARING INDEXABLE PANCAKE DRILLS



15010 ATTACHMENT ONLY
PART OF THE JIFFY MODULAR DRILL SYSTEM

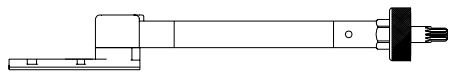

ATTACHMENT SHOWN WITH OPTIONAL
3.75" 95.25mm EXTENSION ASSEMBLY No. 15047

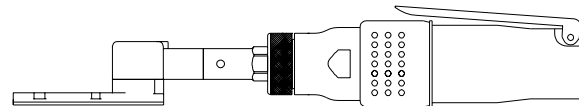

SD2 2700 RPM

The high nickel alloy used in our drill attachment gears make this unit SUPERIOR in drilling performance.

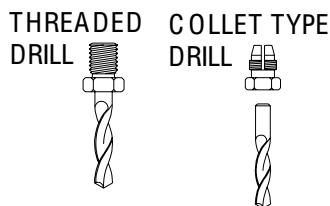

INTERNAL THREAD	
ADD TO TOOL No.	
1/4-28	A
10-32	C
9/32-40	E
5/16-24	F
COLLET	D

TOOL ORDER NUMBER	R.P.M.	LENGTH		WEIGHT	
		Inch	mm	Lbs.	Kg.
SD SERIES .30 HP MOTOR					
16253	250	12.1	307	1.7	.77
15011	500	12.1	307	1.7	.77
15012	750	12.1	307	1.7	.77
15013	1000	12.1	307	1.7	.77
15014	1500	12.1	307	1.7	.77
15015	2800	11.2	284	1.5	.68
SD2 SERIES .60 HP MOTOR					
16254	250	13.5	342	2.9	1.3
15016	450	12.6	320	2.5	1.1
15017	1000	12.6	320	2.5	1.1
15018	2000	11.6	294	2.1	.95
15019	2700	11.6	294	2.1	.95
15020	3500	11.6	294	2.1	.95
SRD2 REVERSIBLE .40 HP MOTOR					
16255	250	13.5	342	2.9	1.3
16256	450	12.6	320	2.5	1.1
16257	1000	12.6	320	2.5	1.1
16258	2000	11.6	294	2.1	.95
16259	2700	11.6	294	2.1	.95