

SCREW ASSEMBLY BEFORE MOUNTING

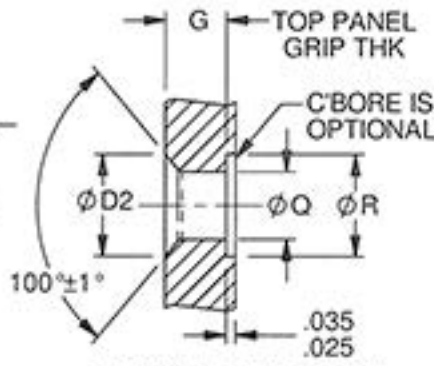

PANEL PREPARATION

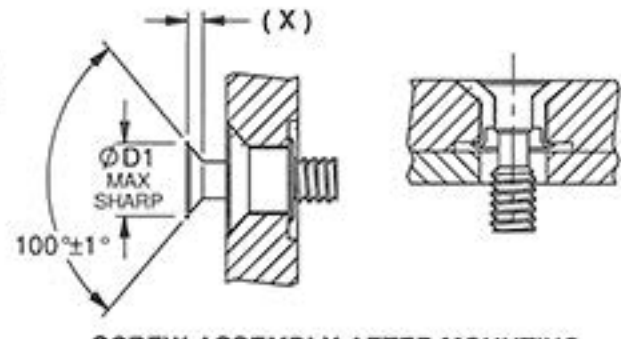

SCREW ASSEMBLY AFTER MOUNTING

THREAD SIZE CODE	Ø D	Ø D1	Ø Ø2				Ø Q	Ø R	T	(X)	Y	RECESS SIZE W			
			+0.010 -0.000	+0.005 -0.005	+0.004 -0.001	+0.020 -0.000						P	TW	TS	HS
4, 4F, M3	.317	.231	.323	.178	.187	.312	.175	.057	.057	.057	4	2	4	1/16	
6, 6F, M3.5	.317	.231	.323	.202	.213	.323	.203	.048	.048	.048	4	2	5	1/16	
8, 8F, M4	.335	.257	.340	.215	.228	.348	.250	.050	.052	.052	6	3	6	1/16	
10, 10C, 10F, M5	.375	.300	.380	.250	.257	.375	.250	.055	.052	.052	6	4	8	5/64	
12, 12C, 12F, M6	.400	.312	.409	.313	.323	.437	.281	.038	.040	.040	8	5	10	5/64	

5

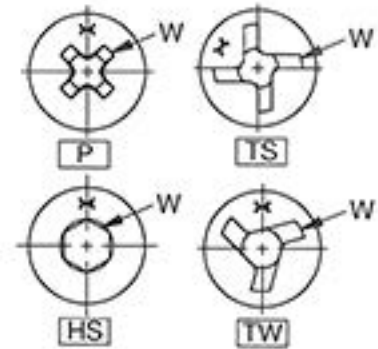

PART NUMBER CALLOUT

DPY() () 7900()-()-()-() ()

MODEL

SERIES

LENGTH CODE	L		LENGTH CODE	L	
	+0.015	-0.015		+0.015	-0.015
1	.300	.285	4.5	.722	.707
1.5	.355	.340	5	.785	.770
2	.410	.395	5.5	.847	.832
2.5	.472	.457	6	.910	.895
3	.535	.520	7	1.035	1.020
3.5	.597	.582	8	1.160	1.145
4	.660	.645			

GRIP CODE	G		K	A	GRIP CODE	G		K	A
	(TOP PANEL GRIP THK)	±.005				(TOP PANEL GRIP THK)	±.005		
A	.075-.089	.120	.075	F	.313-.375	.397	.282		
B	.090-.125	.147	.087	G	.376-.437	.459	.344		
C	.126-.187	.210	.095	H	.438-.500	.521	.406		
D	.188-.250	.272	.157	J	.501-.562	.583	.468		
E	.251-.312	.335	.220	M	.563-.625	.645	.530		

7

THREAD SIZE CODE	THREAD SIZE	LEAD	THREAD SIZE CODE	THREAD SIZE	LEAD
4	.112-40 UNC-2A	SINGLE	8F	.164-32 UNC-2A	QUAD
6	.138-32 UNC-2A		10F	.190-32 UNF-2A	
8	.164-32 UNC-2A		12F	.250-28 UNF-2A	
10	.190-32 UNF-2A		M3	M3 x 0.5-6g	
12	.250-28 UNF-2A	SINGLE (COARSE)	M3.5	M3.5 x 0.6-6g	METRIC
10C	.190-24 UNC-2A		M4	M4 x 0.7-6g	
12C	.250-20 UNC-2A	DOUBLE	M5	M5 x 0.8-6g	
4F	.112-40 UNC-2A		M6	M6 x 1.0-6g	
6F	.138-32 UNC-2A				

FINISH OPTIONS:
SEE TABLE ON
PAGE 2

MATERIAL CODE	MATERIAL
NONE	SEE SHEET 2 FOR MATERIAL
M	6AL-4V TITANIUM STUD WITH A-286 CRES SLEEVE
K	302 CRES STUD/304 CRES SLEEVE

RECESS CODE	DRIVING RECESS AND SPECIFICATION
HS	HEX SOCKET RECESS PER ANSIB 18.3
P	CROSS RECESS PER NASM 9006
TS	RECESS PER NASM 33781
TW	RECESS PER NAS 4000

KEY

AP PER DCN 12953, CHANGED FROM Alcoa Fastening Systems AND AFS TO Alcoa Fastening Systems & Rings AND AFSR

TOLERANCE UNLESS OTHERWISE NOTED:
X = ±.05
XX = ±.02
XXX = ±.015
ANGLES ±0.5°

DRAWN BY: J. SCHLOBOHM
CHECKED BY: SIGNATURE ON FILE

ISSUED: 4/27/2004
REVISED: 3/31/2015
PAGE: 1 OF 2

CAPTIVE SCREW, 100° FLUSH HEAD, OPTIONAL RECESS, CONTROLLED THREAD LENGTH

DPY() 7900
S-0840

DIMENSIONS IN INCHES

This drawing/documentation is controlled by either the Department of State, International Traffic in Arms Regulations or the Department of Commerce, Export Administration Regulations and may require an export license/exception prior to being transferred to a foreign national, inside or outside of the United States. EAR/ECCN EAR99. These commodities, technology or software were exported from the United States in accordance with the Export Administration Regulations. Diversion contrary to U.S. law prohibited.

THIS DRAWING, THE STRUCTURAL DESIGN DISCLOSED THEREIN AND THE TECHNICAL DATA AND ENGINEERING SERVICE REPRESENTED THEREBY ARE THE EXCLUSIVE PROPERTY OF HUCK INTERNATIONAL, INC.

Alcoa Fastening Systems & Rings



CURRENT DESIGN ACTIVITY
 CAGE CODE 0HDW7
 AFSR TUCSON OPERATIONS
 3724 EAST COLUMBIA STREET
 TUCSON, ARIZONA 85714
 PHONE (520) 519-7400
 FAX (520) 519-7454

CAPTIVE SCREW ENGINEERING STANDARD

GRP CODE	4, 4F, M2.5, M3, 6, 6F, M3.5												
	LENGTH CODE												
	1	1.5	2	2.5	3	3.5	4	4.5	5	5.5	6	7	8
A	.140	.195											
B	.113	.160											
C	O	O	.160										
D	O	O	O	.160									
E	O	O	O	O	.160								
F	O	O	O	O	O	.160							
G	O	O	O	O	O	O	.160						
H	O	O	O	O	O	O	O	.160					
J	O	O	O	O	O	O	O	O	.160				
M	O	O	O	O	O	O	O	O	O	.160			

GRP CODE	8, 8F, M, 10, 10C, 10F, M5												
	LENGTH CODE												
	1	1.5	2	2.5	3	3.5	4	4.5	5	5.5	6	7	8
A	.140	.195											
B	.113	.160	.223										
C	O	O	.160	.223									
D	O	O	O	.160	.223								
E	O	O	O	O	.160	.223							
F	O	O	O	O	O	.160	.223						
G	O	O	O	O	O	O	.160	.223					
H	O	O	O	O	O	O	O	.160	.223				
J	O	O	O	O	O	O	O	O	.160	.223			
M	O	O	O	O	O	O	O	O	O	.160	.223		

GRP CODE	12, 12C, 12F, M6												
	LENGTH CODE												
	1	1.5	2	2.5	3	3.5	4	4.5	5	5.5	6	7	8
A	O	.195	.243*										
B	O	.160	.223										
C	O	O	.160	.223									
D	O	O	O	.160	.223								
E	O	O	O	O	.160	.223							
F	O	O	O	O	O	.160	.223						
G	O	O	O	O	O	O	.160	.223					
H	O	O	O	O	O	O	O	.160	.223				
J	O	O	O	O	O	O	O	O	.160	.223			
M	O	O	O	O	O	O	O	O	O	.160	.223		

ASSEMBLIES NOT AVAILABLE * SEE NOTE 4
 INDICATES FULL THREAD LENGTH "T" UNLESS NOTED OTHERWISE

INSTALLATION TOOLS: () INDICATES THREAD SIZE CODE

ARBOR PRESS TOOL HW7600-(), NOSE PIECE HN7513-(),
 PULLER HP7523-(), HANDLE ASSEMBLY TA7533, REMOVAL
 ADAPTER TOOL FN7505-()
 COMPLETE HANDLE TOOL ASSEMBLY: H8603-() INCLUDES
 NOSE PIECE, PULLER & HANDLE

NOTES UNLESS SPECIFIED OTHERWISE:

- LETTERS AT THE END OF PART NUMBER DESIGNATE SPECIAL ASSEMBLIES:
 DL - DRI LUBE THREADS PER ASS272
 PL - PATCH LOCK PER ML-DTL-18240
- FOR LONGER LENGTHS, ADD .125 INCREMENTS PER LENGTH CODE
- .2A THREADS PER FED STD-H28/2. METRIC THREADS PER ASME B1.13M.
- CHECK THREAD LENGTH TABLES FOR AVAILABILITY. "T" DIMENSION FOR 12C-A-2 IS .223.
- Ø "N" IS .226 MAX. FOR BLACK PARTS CALLOUT DPYE7900()-8-()-()
- DPYC7900 AVAILABLE IN THREAD SIZE CODES 4, 6, M3, M3.5 ONLY.
- NOT APPLICABLE TO "A" GRIP ALUMINUM OR BRASS SLEEVE CAPTIVE SCREW ASSEMBLIES.

PART	PART NUMBER	RECESS CODE	THREAD SIZE	MATERIAL	FINISH	
STUD	DPY	P, HS	4, 6, M3, M3.5	4037 ALLOY STEEL PER AMS 6300, HEAT TREAT TO HRC 34-38 OR 8740 ALLOY STEEL PER AMS 6322	CAD PLATE PER AMS QQ-P-416, TYPE I, CLASS 2	
	DPYC				CAD PLATE PER AMS QQ-P-416, TYPE II, CLASS 2	
	DPYE				BLACK OXIDE PER ML-DTL-13924, CLASS 1	
	DPY	P, HS	8, 10, 12, M4, M5, M6	302 CRES PER AMS 5636 OR ASTM-A-493	PASSIVATE PER AMS2700	
	DPYE				BLACK OXIDE PER ML-DTL-13924, CLASS 4	
	DPYKE				PASSIVATE PER AMS2700	
	DPYK	P, HS	ALL SIZES			
	DPYT	P, TS, TW				
	SLEEVE	DPY	P, HS, TS, TW	4, 6, M3, M3.5	A-286 CRES PER AMS 5737, HEAT TREAT TO 160 KSI ULTIMATE TENSILE STRENGTH	PASSIVATE PER AMS2700
		DPYC				BLACK OXIDE PER ML-DTL-13924, CLASS 3
DPYE		BLACK OXIDE PER ML-DTL-13924, CLASS 3				
DPYM		P	ALL SIZES	6AL-4V TITANIUM PER AMS 4028 OR AMS 4967	ANODIZE PER AMS 2488	
DPYKC		P	ALL SIZES	302 CRES PER AMS 5636 OR ASTM-A-493	CAD PLATE PER AMS QQ-P-416, TYPE II, CLASS 2	
SLEEVE		DPY	P, HS, TS, TW	4, 6, M3, M3.5	COMMERCIAL BRASS PER AMS 4610, ASTM B 16/B 16M, OR EQUIVALENT	CAD PLATE PER AMS QQ-P-416, TYPE I, CLASS 2
	DPYC	CAD PLATE PER AMS QQ-P-416, TYPE II, CLASS 2				
	DPYE	BLACK CHEMICAL PER ML-F-495				
	DPYT	P, TS, TW	ALL SIZES	6061 ALUMINUM ALLOY PER AMS 4117, AMS QQ-A-225/8, OR EQUIVALENT	ANODIZE PER ML-A-8625, TYPE II, CLASS 1	
	DPY	P, HS, TS, TW	8, 10, 12, M4, M5, M6	304 CRES PER AMS 5639 OR QQ-S-763	BLACK ANODIZE PER ML-A-8625, TYPE II, CLASS 2	
	DPYE				BLACK OXIDE PER ML-DTL-13924, CLASS 4	
	DPYKE				PASSIVATE PER AMS2700	
	DPYK	P, HS	ALL SIZES	A-286 CRES PER AMS 5737, HEAT TREAT TO 160 KSI UTS	PASSIVATE PER AMS2700	
	DPYM	P	ALL SIZES	304 CRES PER AMS 5639 OR QQ-S-763	CAD PLATE PER AMS QQ-P-416, TYPE II, CLASS 2	
	DPYKC	P	ALL SIZES	304 CRES PER AMS 5639 OR QQ-S-763	CAD PLATE PER AMS QQ-P-416, TYPE II, CLASS 2	

PER DCN 12953, CHANGED FROM Alcoa Fastening Systems AND AFS TO Alcoa Fastening Systems & Rings AND AFSR

ISSUED 4/27/2004
 REVISED 3/31/2015
 PAGE 2 OF 2

CAPTIVE SCREW, 100° FLUSH HEAD, OPTIONAL RECESS, CONTROLLED THREAD LENGTH

TOLERANCE UNLESS OTHERWISE NOTED:
 X = ±.05
 XX = ±.02
 XXX = ±.015
 ANGLES ±0.5°

DRAWN BY J. SCHLOBHM
 CHECKED BY SIGNATURE ON FILE

DPY()7900
 S-0840

DIMENSIONS IN INCHES

This drawing/documentation is controlled by either the Department of State, International Traffic in Arms Regulations or the Department of Commerce, Export Administration Regulations and may require an export license/exception prior to being transferred to a foreign national, inside or outside of the United States. EAR/ECCN EAR99. These commodities, technology or software were exported from the United States in accordance with the Export Administration Regulations. Diversion contrary to U.S. law prohibited.

THIS DRAWING, THE STRUCTURAL DESIGN DISCLOSED THEREIN AND THE TECHNICAL DATA AND ENGINEERING SERVICE REPRESENTED THEREBY ARE THE EXCLUSIVE PROPERTY OF ALCOA INTERNATIONAL, INC.