

# Alcoa Fastening Systems & Rings



CURRENT DESIGN ACTIVITY  
 CAGE CODE 0HDW7  
 AFSR TUCSON OPERATIONS  
 3724 EAST COLUMBIA STREET  
 TUCSON, ARIZONA 85714  
 PHONE (520) 519-7400  
 FAX (520) 519-7454

# CAPTIVE SCREW

## ENGINEERING STANDARD

THIS DRAWING, THE STRUCTURAL DESIGN DISCLOSED THEREIN AND THE TECHNICAL DATA AND ENGINEERING SERVICE REPRESENTED THEREBY ARE THE EXCLUSIVE PROPERTY OF HUCK INTERNATIONAL, INC.

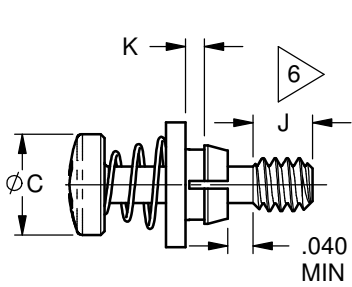
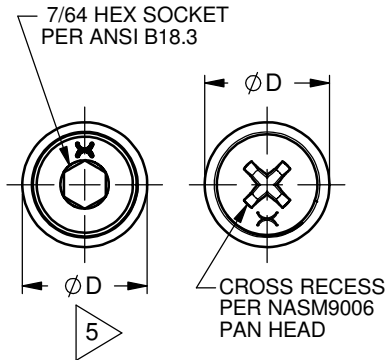

**SCREW ASSEMBLY BEFORE MOUNTING**

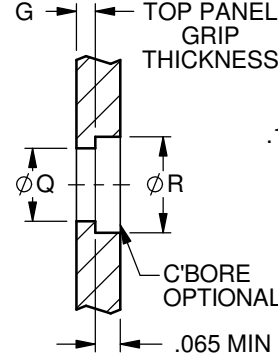

**PANEL PREPARATION**

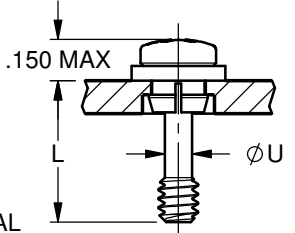

**SCREW ASSEMBLY AFTER MOUNTING**

THREAD SIZE CODE	Ø C MAX	Ø D ±.010	Ø Q +.004 - .001	Ø R +.020 - .000	Ø U +.005 - .000
4	.219	.250	.162	.206	.075
6	.270	.325	.190	.219	.090
8	.322	.375	.228	.250	.117

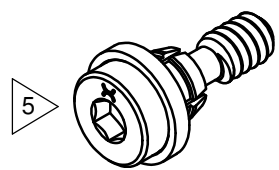

**PART NUMBER CALLOUT**

CFB ( ) 7950 ( ) - ( ) - ( ) - ( )

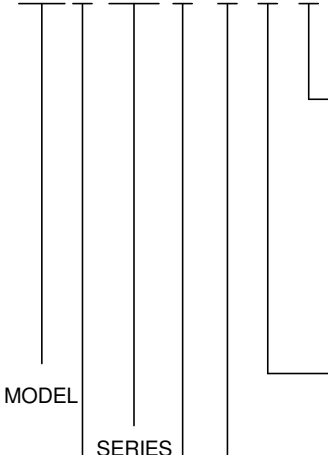

LENGTH CODE	L
6.5	.375
7	.425
8	.500
8.3	.530
8.5	.550
9	.562
10	.625
17	1.062

GRIP CODE	G TOP PANEL GRIP THICKNESS	K +.010 - .000
A	.031-.049	.050
B	.050-.075	.076
C	.076-.105	.106

THREAD SIZE CODE	THREAD SIZE PER ASME B1.1
4	.112-40 UNC-3A
6	.138-32 UNC-3A
8	.164-32 UNC-3A

MATERIAL CODE	SCREW MATERIAL
NONE	302 CRES
L	A-286 CRES

THREAD LENGTH CODE	J THREAD SIZE		
	4	6	8
A	.155	.250	.250
T	.250	.155	N/A
N	N/A	.500	N/A
R	N/A	.250	N/A

SIZE 8 AVAILABILITY	
A	7 OR LONGER
B	8 OR LONGER
C	8.3 OR LONGER

**NOTES:**

- SCREW HAS .015 TOTAL FLOAT
- THIS LENGTH IS ONLY AVAILABLE FOR CFB7950( )-4 AND CFBT 7950( )-6.
- SEE TABLE FOR SIZE 8 AVAILABILITY.
- 17 LENGTH ONLY.
- THIS HEAD STYLE IS ONLY AVAILABLE FOR CFB7950(L)-6.
- SPECIFIED THREAD LENGTH AVAILABILITY LIMITED BY SLEEVE GRIP/STUD LENGTH COMBINATION.

**MATERIAL:**

**SCREW:**  
 CFB( )7950: 302 CRES PER ASTM-A-493 OR AMS 5636  
 CFB( )7950L: A-286 CRES PER AMS 5732 OR AMS 5737, HEAT TREAT TO 160KSI MIN. U.T.S

**SLEEVE:**  
 7075-T6 OR 7075-T4 ALUMINUM ALLOY PER AMS 4122 OR AMS QQ-A-225/9

**SPRING:**  
 302 CRES PER AMS 5688 OR ASTM-A-313

**FINISH:**

CFB( )7950(L) EXCEPT CFB7950(L):

SCREW: BLACK OXIDE PER MIL-DTL-13924, CLASS 3 (A-286) OR CLASS 4 (302)

SLEEVE: BLACK ANODIZE PER MIL-A-8625, TYPE II, CLASS 2

SPRING: BLACK OXIDE PER MIL-DTL-13924, CLASS 4

CFBR7950, CFBR7950L:  
 SCREW & SPRING: PASSIVATE PER AMS2700.  
 SLEEVE: BLACK ANODIZE PER MIL-A-8625, TYPE II, CLASS 2

ISSUED	2/10/2006	CAPTIVE SCREW, SNAP-IN, FLOATING, SPRING-LOADED, OPTIONAL RECESS,	TOLERANCE UNLESS OTHERWISE NOTED: .X = ±.05 .XX = ±.02 .XXX = ±.015 ANGLES ±0.5°	DRAWN BY	J. SCHLOBOHM	
	REVISED			3/31/2015	CHECKED BY	SIGNATURE ON FILE
	PAGE			1 OF 1	<b>CFB( )7950</b> <b>S-2825</b>	

This drawing/documentation is controlled by either the Department of State, International Traffic in Arms Regulations or the Department of Commerce, Export Administration Regulations and may require an export license exception prior to being transferred to a foreign national, inside or outside of the United States. EAR/ECCN EAR99. These commodities, technology or software were exported from the United States in accordance with the Export Administration Regulations. Diversion contrary to U.S. law prohibited.