

BASEPLATE
RETAINER
THREAD T
PER MIL-S-8879.
RADIAL FLOAT OF
NUT ELEMENT .030
FROM CENTER. NUT CAN
ENGAGE SCREW FROM
MAX MISALIGNED POSITION.
NUT
NUT MAY BE REMOVED FROM
RETAINER AND REPLACED.
THREAD LOCK PER NASM25027.
DRI-FILM LUBE ON NUT PER
MIL-L-46010 TYPE 1.

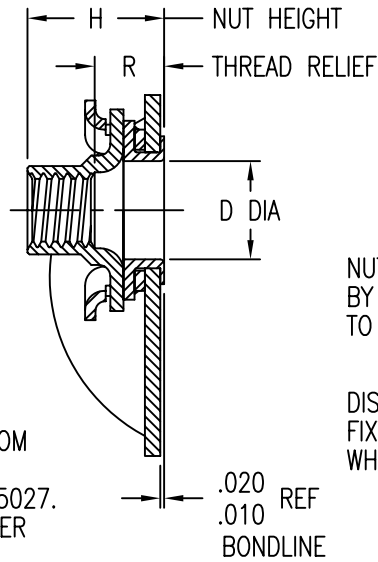

NUTPLATE ATTACHED
BY ADHESIVE APPLIED
TO THIS SURFACE.

DISPOSABLE ELASTIC
FIXTURE HOLDS NUTPLATE
WHILE ADHESIVE CURES.

NUTPLATE MEETS THE STRENGTH
REQUIREMENTS OF NASM25027.

MATERIAL AND FINISH DATA

CODE	NUT MATERIAL	SPEC.	RETAINER MATERIAL	SPEC.	FINISH	SPEC.
CR	A-286 CRES	AMS 5525	17-7PH, A-286, 304, 305 CRES	AMS 5528, 5525, 5514, 5639	PASSIVATE	QQ-P-35
CRA	A-286 CRES	AMS 5525	17-7PH, A-286, 304, 305 CRES	AMS 5528, 5525, 5514, 5639	PASSIVATE	QQ-P-35

THREAD T DATA AND DIMENSIONS

COUNTERBORE DATA - THD. RELIEF R AND NUT HEIGHT H

CODE	THREAD SIZE	A	B	C	D	E	CODE	NONE	2	3	4	5	6
08	.1640-32 UNJC-3B	.948	.525	.35	.250	.300	R ±.025	.120	.165	.228	.291	.354	.417
3	.1900-32 UNJF-3B						H ±.025	.300	.362	.424	.486	.549	.612
4	.2500-28 UNJF-3B	1.292	.610	.45	.310	.350	R ±.025	.150	.235	.298	.361	.424	.488
							H ±.025	.362	.424	.487	.549	.609	.672

MINIMUM NUT HEIGHT H LIMITED BY STRENGTH REQUIREMENTS ONLY.

CODE	BASEPLATE MATERIAL
C	CARBON/EPOXY, 350°F
G	GLASS/EPOXY, 250°F
E	GLASS/EPOXY, 350°F

EXAMPLE PART NUMBER

CB4011 G 3 CRA 2

↑ BASIC PART NUMBER
↑ BASEPLATE MATERIAL - GLASS/EPOXY, 250°F
↑ THREAD SIZE T - .1900-32 UNJF-3B
↑ NUT MATERIAL - A-286 CRES; RETAINER MATERIAL - CRES
↑ THREAD RELIEF CODE - 2

UNLESS OTHERWISE SPECIFIED, ALL DIMENSIONS ARE IN INCHES AND TOLERANCES ARE AS SHOWN BELOW. DIMENSIONAL TOLERANCES AND SYMBOLS PER ANSI Y14.5M-1982.

PROPRIETARY PARTS SHOWN IN THIS DRAWING ARE THE SUBJECT OF ISSUED UNITED STATES AND FOREIGN PATENTS AND PATENTS PENDING. UNAUTHORIZED REPRODUCTION AND/OR DISTRIBUTION OF THIS DRAWING IS SPECIFICALLY PROHIBITED.

GLICK BOND

CARSON CITY
NEVADA 89706

CAD CB4011-1		APPROVALS	DATE
ANGLES	±1°	DRAWN BSP	27JUN01
.XX	±.03	CHECKED DAC	27JUN01
.XXX	±.010	RELEASED CGH	5JUL01
.XXXX	±.001	REVISED BSP	27JUN01

TITLE			
NUTPLATE, ONE LUG, COMPOSITE BASE			
SIZE	CAGE CODE	DWG. NO.	REV.
A	66530	CB4011	8
SCALE	2/1		27JUN01
SHEET 1 OF 2			

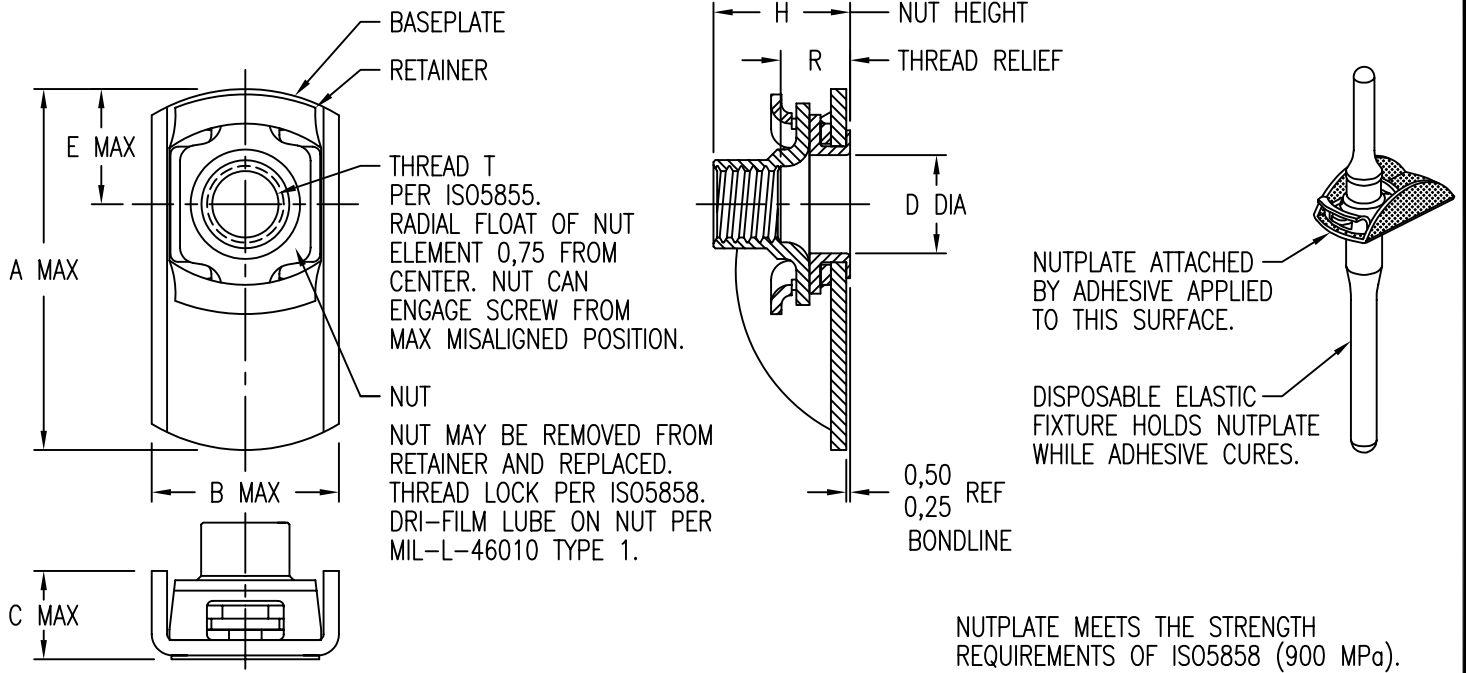

MATERIAL AND FINISH DATA

CODE	NUT MATERIAL	SPEC.	RETAINER MATERIAL	SPEC.	FINISH	SPEC.
CR	A-286 CRES	AMS 5525	17-7PH, A-286, 304, 305 CRES	AMS 5528, 5525, 5514, 5639	PASSIVATE	QQ-P-35
CRA	A-286 CRES	AMS 5525	17-7PH, A-286, 304, 305 CRES	AMS 5528, 5525, 5514, 5639	PASSIVATE	QQ-P-35

THREAD T DATA AND DIMENSIONS

CODE	THREAD SIZE	A	B	C	D	E	COUNTERBORE DATA - THD. RELIEF R AND NUT HEIGHT H						
							CODE	NONE	2	3	4	5	6
4M	MJ4 X 0,7 4H6H	24,1	13,4	8,9	6,35	7,65	R ±0,65	3,05	4,19	5,79	7,39	8,99	10,59
5M	MJ5 X 0,8 4H6H						H ±0,65	7,62	9,19	10,77	12,34	13,94	15,54
6M	MJ6 X 1,0 4H5H	32,9	15,5	11,5	7,87	8,90	R ±0,65	3,81	5,97	7,57	9,17	10,77	12,40
							H ±0,65	9,19	10,77	12,37	13,94	15,47	17,07

MINIMUM NUT HEIGHT H LIMITED BY STRENGTH REQUIREMENTS ONLY.

CODE	BASEPLATE MATERIAL
C	CARBON/EPOXY, 177°C
G	GLASS/EPOXY, 121°C
E	GLASS/EPOXY, 177°C

EXAMPLE PART NUMBER

CB4011 G 5M CRA 2

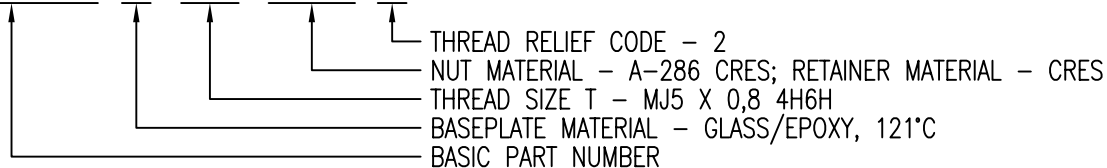

UNLESS OTHERWISE SPECIFIED, ALL DIMENSIONS ARE IN MILLIMETERS AND TOLERANCES ARE AS SHOWN BELOW. DIMENSIONAL TOLERANCES AND SYMBOLS PER ANSI Y14.5M-1982.

PROPRIETARY PARTS SHOWN IN THIS DRAWING ARE THE SUBJECT OF ISSUED UNITED STATES AND FOREIGN PATENTS AND PATENTS PENDING. UNAUTHORIZED REPRODUCTION AND/OR DISTRIBUTION OF THIS DRAWING IS SPECIFICALLY PROHIBITED.



CARSON CITY
NEVADA 89706

CAD CB4011-2 METRIC DIMENSIONS		APPROVALS		DATE	TITLE			
ANGLES ±1°		DRAWN	BSP	27JUN01	NUTPLATE, ONE LUG, COMPOSITE BASE			
.X	±0,8	CHECKED	DAC	27JUN01	SIZE	CAGE CODE	DWG. NO.	REV.
.XX	±0,25	RELEASED	CGH	5JUL01	A	66530	CB4011 (METRIC)	8
		REVISED	BSP	27JUN01	SCALE	2/1	27JUN01	SHEET 2 OF 2