

DIMENSION DATA

PART NO.	A ±.005	B ±.010	C ±.015	D ±.005	E REF	N ±.005	T ±.005	R ₁	R ₂	R ₃	R ₄	WEIGHT * LB/100
CB6002-3	.100	.194	.474	.184	.17	.050	.032	.100	.080	.065	.171	.05
CB6002-4	.110	.253	.574	.210	.23	.062	.032	.140	.090	.062	.215	.08
CB6002-5	.125	.286	.710	.215	.26	.062	.032	.156	.055	.055	---	.10
CB6002-6	.125	.330	.800	.215	.24	.062	.042	.210	.055	.055	---	.15
CB6002-7	.150	.330	.890	.250	.31	.072	.042	.210	.055	.055	---	.20
CB6002-8	.150	.380	.960	.285	.32	.072	.042	.230	.090	.085	---	.22

* REFERENCE WEIGHT.

MATERIAL: 302 CRES PER AMS 5688 OR 5866, OR ARMC0 18-2 MN CRES.
FINISH: PASSIVATE PER QQ-P-35

① NOTE: C +.025 PERMISSIBLE, PROVIDING CLIP MEETS ALL OTHER DIMENSIONS WHEN HELD COMPRESSED TO C ±.015.

EXAMPLE PART NUMBER

CB6002-3



UNLESS OTHERWISE SPECIFIED, ALL DIMENSIONS ARE IN INCHES AND TOLERANCES ARE AS SHOWN BELOW. DIMENSIONAL TOLERANCES AND SYMBOLS PER ANSI Y14.5M-1982.

PROPRIETARY PARTS SHOWN IN THIS DRAWING ARE THE SUBJECT OF ISSUED UNITED STATES AND FOREIGN PATENTS AND PATENTS PENDING. UNAUTHORIZED REPRODUCTION AND/OR DISTRIBUTION OF THIS DRAWING IS SPECIFICALLY PROHIBITED.

GLICK BOND

CARSON CITY
NEVADA 89706

CAD CB6002-1

APPROVALS	DATE
DRAWN DAC	15MAY99
CHECKED DAC	15MAY99
RELEASED CGH	16MAY99
REVISED DAC	15MAY99

TITLE			
CLIP, NUT RETAINING			
SIZE	CAGE CODE	DWG. NO.	REV.
A	66530	CB6002	3
SCALE	2/1 15MAY99		SHEET 1 OF 2

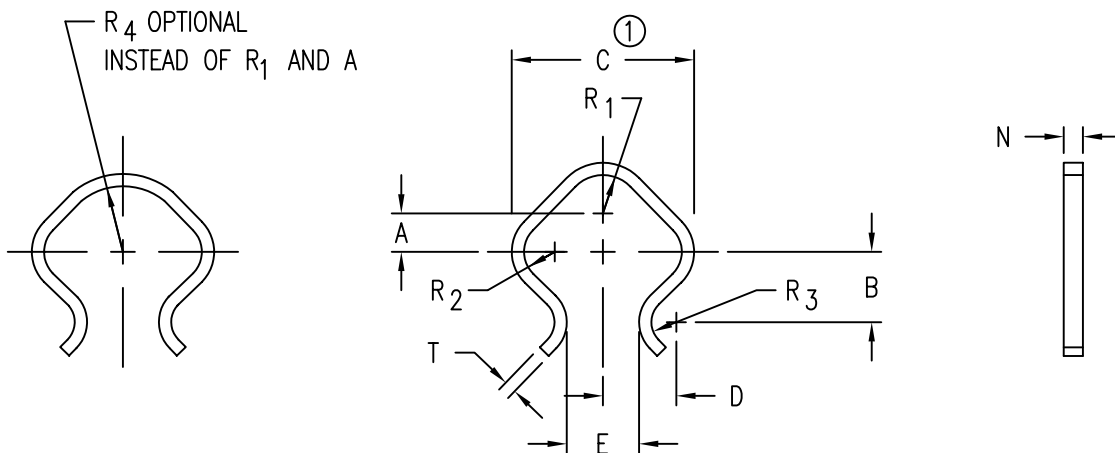

DIMENSION DATA

PART NO.	A	B	C	D	E	N	T	R ₁	R ₂	R ₃	R ₄	WEIGHT * GRAMS
CB6002-5M	±0,15	±0,25	±0,40	±0,15	REF	±0,15	±0,15	R ₁	R ₂	R ₃	R ₄	0,23
CB6002-6M	2,79	6,43	14,58	5,33	5,85	1,57	0,81	3,56	2,29	1,57	5,46	0,37
CB6002-8M	3,18	7,26	18,03	5,46	6,60	1,57	0,81	3,96	1,40	1,40	---	0,44
CB6002-10M	3,18	8,38	20,32	5,46	6,10	1,57	1,07	5,33	1,40	1,40	---	0,69

* REFERENCE WEIGHT.

MATERIAL: 302 CRES PER AMS 5688 OR 5866, OR ARMC0 18-2 MN CRES.
FINISH: PASSIVATE PER QQ-P-35

① NOTE: C +0,65 PERMISSIBLE, PROVIDING CLIP MEETS ALL OTHER DIMENSIONS WHEN HELD COMPRESSED TO C ±0,40.

EXAMPLE PART NUMBER

CB6002-5M

CLIP SIZE - SEE NUTPLATE DRAWING FOR PROPER DASH NUMBER
BASIC PART NUMBER

UNLESS OTHERWISE SPECIFIED, ALL DIMENSIONS ARE IN MILLIMETERS AND TOLERANCES ARE AS SHOWN BELOW. DIMENSIONAL TOLERANCES AND SYMBOLS PER ANSI Y14.5M-1982.

PROPRIETARY PARTS SHOWN IN THIS DRAWING ARE THE SUBJECT OF ISSUED UNITED STATES AND FOREIGN PATENTS AND PATENTS PENDING. UNAUTHORIZED REPRODUCTION AND/OR DISTRIBUTION OF THIS DRAWING IS SPECIFICALLY PROHIBITED.

GLICK BOND

CARSON CITY
NEVADA 89706

CAD CB6002-2
METRIC DIMENSIONS

APPROVALS	DATE
DRAWN DAC	15MAY99
CHECKED DAC	15MAY99
RELEASED CGH	16MAY99
REVISED DAC	15MAY99

TITLE			
CLIP, NUT RETAINING			
SIZE	CAGE CODE	DWG. NO.	REV.
A	66530	CB6002 (METRIC)	3
SCALE	2/1 15MAY99		SHEET 2 OF 2