

REV **R**  
**S-2861**

DRAWING NO.

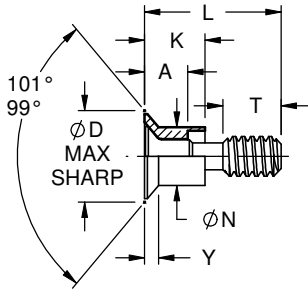

**SCREW ASSEMBLY BEFORE MOUNTING**

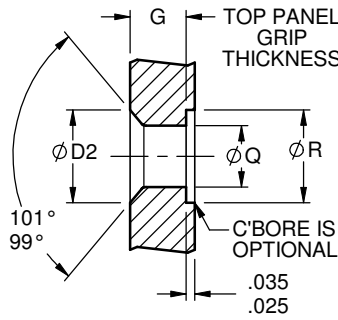

**PANEL PREPARATION**

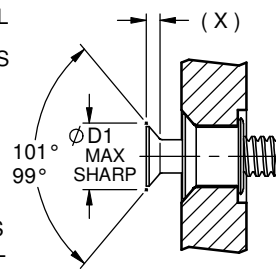

**SCREW ASSEMBLY AFTER MOUNTING**

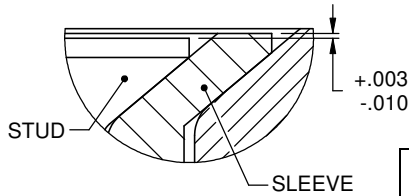
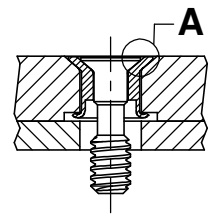

**DETAIL A  
SCALE 10 : 1**

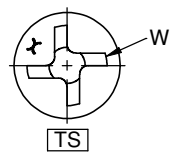
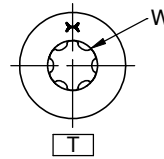
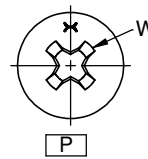
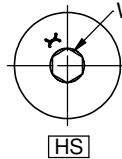

THREAD SIZE CODE	Ø D	Ø D1	Ø D2 +.010 -.000	Ø N +.005 -.005	Ø Q +.004 -.001	Ø R +.020 -.000	T	(X)	Y	DRIVER SIZE 'W'			
										P	TS	T	HS
4, 4F, M3	.317	.231	.323	.178	.187	.312	.175	.057	.057	1	4	8 IP	1/16
6, 6F, M3.5	.317	.231	.323	.202	.213	.323	.203	.048	.048	1	5		
8, 8F, M4	.335	.257	.340	.215	.228	.348	.250	.050	.052	2	6	10 IP	
10, 10C, 10F, M5	.375	.300	.380	.250	.257	.375	.250	.055	.052	2	8	15 IP	5/64
12, 12C, 12F, M6	.400	.312	.409	.313	.323	.437	.281	.040	.040	2	10		

**PART NUMBER CALLOUT**

DPY ( ) 7900 ( ) - ( ) - ( ) - ( ) ( )

LENGTH CODE	L ±.015	LENGTH CODE	L ±.015
1	.300	4.5	.722
1.5	.355	5	.785
2	.410	5.5	.847
2.5	.472	6	.910
3	.535	7	1.035
3.5	.597	8	1.160
4	.660	8.5	1.222

GRIP CODE	G (TOP PANEL GRIP THK)			GRIP CODE	G (TOP PANEL GRIP THK)		
	K ±.005	A ±.005	A ±.005		K ±.005	A ±.005	A ±.005
A	.075-.089	.120	.075	F	.313-.375	.397	.282
B	.090-.125	.147	.087	G	.376-.437	.459	.344
C	.126-.187	.210	.095	H	.438-.500	.521	.406
D	.188-.250	.272	.157	J	.501-.562	.583	.468
E	.251-.312	.335	.220	M	.563-.625	.645	.530

MODEL

SERIES

THREAD SIZE CODE	THREAD SIZE	LEAD	THREAD SIZE CODE	THREAD SIZE	LEAD
4	.112-40 UNC-( )	SINGLE	8F	.164-32 UNC-( )	QUAD
6	.138-32 UNC-( )		10F	.190-32 UNF-( )	
8	.164-32 UNC-( )		12F	.250-28 UNF-( )	
10	.190-32 UNF-( )		M3	M3 x 0.5-6( )	METRIC
12	.250-28 UNF-( )		M3.5	M3.5 x 0.6-6( )	
10C	.190-24 UNC-( )	M4	M4 x 0.7-6( )		
12C	.250-20 UNC-( )	SINGLE (COARSE)	M5	M5 x 0.8-6( )	
4F	.112-40 UNC-( )	DOUBLE	M6	M6 x 1.0-6( )	
6F	.138-32 UNC-( )				

CODE	FINISH
NONE	CLEAR
E	BLACK

RECESS CODE	DRIVING RECESS AND SPECIFICATION
HS	HEX SOCKET RECESS PER ANSI B18.3
P	CROSS RECESS PER NASM 9006
T	TORX PLUS RECESS PER NIH-301
TS	RECESS PER NASM 33781

CODE	OPTION
S	ALL THREADS CLASS 2A & 6g
G	ALL THREADS CLASS 3A & 6h

REV	DESCRIPTION/EC NO.	DATE
R	DCN 9271	10-07-10
P	DCN 6289	03-06-08

UNLESS OTHERWISE SPECIFIED ALL DIMENSIONS IN INCHES

TOLERANCE UNLESS OTHERWISE NOTED:  
.X = ±.05 ANGLES ±0.5°  
.XX = ±.02  
.XXX = ±.015

**ALCOA** **Alcoa Fastening Systems**  
AEROSPACE FASTENER DIVISION  
3724 EAST COLUMBIA STREET  
TUCSON, ARIZONA 85714  
PHONE 520 519-7400  
FAX 520 519-7427

TITLE  
**CAPTIVE SCREW, 100° FLUSH HEAD, OPTIONAL RECESS, FIXED THREAD LENGTH**

DATE 10-20-05	PART NUMBER <b>DPY( ) ( )7900</b>
DRAWN J. SCHLOBOHM	SIGNER INITIALS DRAWING NO. <b>S-2861</b>
CHECK J. CALLAWAY	CAGE CODE 0HDW7
APPROVE J. HEIN	REV <b>R</b>
SCALE: 1:1 SHEET 1 OF 2	

THIS DRAWING, THE STRUCTURAL DESIGN DISCLOSED THEREIN, THE TECHNICAL DATA AND ENGINEERING SERVICE REPRESENTED THEREBY ARE THE EXCLUSIVE PROPERTY OF HUCK INTERNATIONAL, INC.

REV  
**R****S-2861**

DRAWING NO.

GRIP CODE	4, 4F, M2.5, M3, 6, 6F, M3.5											GRIP CODE	8, 8F, M4, 10, 10C, 10F, M5													
	LENGTH CODE												LENGTH CODE													
	1	1.5	2	2.5	3	3.5	4	4.5	5	5.5	6-8.5		1	1.5	2	2.5	3	3.5	4	4.5	5	5.5	6	7	8	8.5
A	.140											A	.140	.195												
B	.113	.160										B	.113	.160	.223											
C	O	O	.160									C	O	O	.160	.223										
D	O	O	O	.160								D	O	O	O	.160	.223									
E	O	O	O	O	.160							E	O	O	O	O	.160	.223								
F	O	O	O	O	O	.160						F	O	O	O	O	O	.160	.223							
G	O	O	O	O	O	O	.160					G	O	O	O	O	O	.160	.223							
H	O	O	O	O	O	O	O	.160				H	O	O	O	O	O	O	.160	.223						
J	O	O	O	O	O	O	O	O	.160			J	O	O	O	O	O	O	O	.160	.223					
M	O	O	O	O	O	O	O	O	O	.160		M	O	O	O	O	O	O	O	O	.160	.223				

GRIP CODE	12, 12C, 12F, M6												
	LENGTH CODE												
	1	1.5	2	2.5	3	3.5	4	4.5	5	5.5	6	7	8
A	O	.195	.250										
B	O	.160	.223										
C	O	O	.160	.223									
D	O	O	O	.160	.223								
E	O	O	O	O	.160	.223							
F	O	O	O	O	O	.160	.223						
G	O	O	O	O	O	O	.160	.223					
H	O	O	O	O	O	O	O	.160	.223				
J	O	O	O	O	O	O	O	O	.160	.223			
M	O	O	O	O	O	O	O	O	.160	.223			



ASSEMBLIES NOT AVAILABLE



INDICATES FULL THREAD LENGTH "T" UNLESS NOTED OTHERWISE

**MATERIAL :**

STUD : A-286 CRES PER AMS 5737 OR EQUIV., HEAT TREAT TO 160 KSI ULTIMATE TENSILE STRENGTH  
 SLEEVE : 304 CRES PER AMS 5639 AND AMS QQ-S-763

**FINISH :**

DPY ( ) 7900 ( ) : BOTH COMPONENTS: PASSIVATE PER AMS2700  
 DPY ( ) E7900 ( ) : STUD: BLACK OXIDE PER MIL-C-13924, CLASS 3  
 SLEEVE: BLACK OXIDE PER MIL-C-13924, CLASS 4

**NOTES:**

- 1 ▷ CHARACTERS AT THE END OF THE PART NUMBER DESIGNATE SPECIAL ASSEMBLIES:  
 AC - ALUMINUM PIGMENTED COATING PER NAS 4006 (ENTIRE ASSEMBLY)  
 DL - DRI-FILM LUBRICATED THREADS PER MIL-PRF-46010  
 PL - PATCH LOCK PER MIL-DTL-18240  
 X1 - X8 - EXTENDED THREAD LENGTH. CONTACT FACTORY FOR AVAILABILITY
- 2 ▷ FOR LONGER LENGTHS, ADD .125 INCREMENTS PER LENGTH CODE
- 3 ▷ -2A & -3A THREADS PER ASME B1.1. METRIC THREADS PER ASME B1.13M.
- 4 ▷ .062 FOR SIZE 12
- 5 MINIMUM SHEET THICKNESS WHEN INSTALLING DIMPLED APPLICATION IS .040.
- 6 ▷ RECESS IS ONE SIZE SMALLER THAN NOMINAL SIZE REQUIRED FOR 100° FLUSH HEAD PER NASM 9006.
- 7 ▷ RECESS SIZE AND DEPTH ADJUSTED TO ALLOW FOR REDUCED HEAD DIAMETER
- 8 ▷ AFS PART NUMBER MAY HAVE NON-SIGNIFICANT CHARACTERS REMOVED TO FIT WITHIN MANUFACTURING SYSTEM FIELD LENGTH LIMITATION. EX: DPGY7900TS-M3.5-B-2.5 SHORTENED TO DPGY79TS-M3.5-B-25

TORXplus® IS A REGISTERED TRADEMARK OF ACUMENT GLOBAL TECHNOLOGIES.

INSTALLATION TOOLS: ( ) INDICATES THREAD SIZE CODE

ARBOR PRESS TOOL HW7600-( ), NOSE PIECE HN7513-( ), PULLER HP7523-( ), HANDLE ASSEMBLY TA7533

COMPLETE HAND TOOL ASS'Y H8603-( ) INCLUDES NOSE PIECE, PULLER & HANDLE

R	DCN 9271	10-07-10
P	DCN 6289	03-06-08
REV	DESCRIPTION/EC NO.	DATE

UNLESS OTHERWISE SPECIFIED  
ALL DIMENSIONS IN INCHES

TOLERANCE UNLESS OTHERWISE  
NOTED:

.X = ±.05      ANGLES ±0.5°  
 .XX = ±.02  
 .XXX = ±.015



**Alcoa Fastening  
Systems**

AEROSPACE FASTENER DIVISION  
3724 EAST COLUMBIA STREET  
TUCSON, ARIZONA 85714  
PHONE 520 519-7400  
FAX 520 519-7427

TITLE

**CAPTIVE SCREW, 100° FLUSH  
HEAD, OPTIONAL RECESS,  
FIXED THREAD LENGTH**

DATE	10-20-05	PART NUMBER	DPY( ) ( )7900
DRAWN	J. SCHLOBOHM	SIGNER INITIALS	
CHECK	J. CALLAWAY	DRAWING NO.	S-2861
APPROVE	J. HEIN	CAGE CODE	OHDW7
		REV	R
		SCALE: 1:1	SHEET 2 OF 2

THIS DRAWING, THE STRUCTURAL DESIGN DISCLOSED THEREIN, THE TECHNICAL DATA AND ENGINEERING SERVICE REPRESENTED THEREBY ARE THE EXCLUSIVE PROPERTY OF HUCK INTERNATIONAL, INC.