

THREAD T DATA

CODE	THREAD T	
	CR MATERIAL	BC MATERIAL
3	.1900-32 UNJF-3A	.1900-32 UNF-2A
4	.2500-28 UNJF-3A	.2500-28 UNF-2A
5	.3125-24 UNJF-3A	.3125-24 UNF-2A

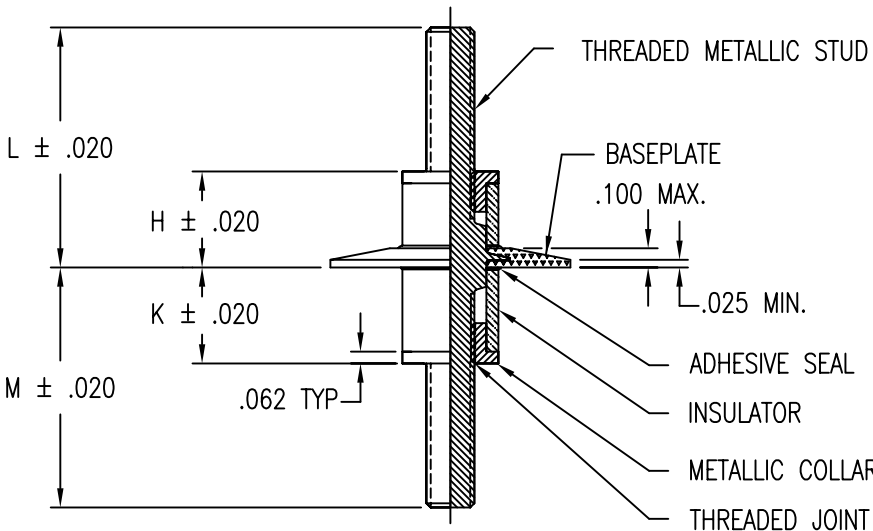

DISPOSABLE PRESSURE SENSITIVE ADHESIVE FIXTURE HOLDS FEEDTHRU WHILE ADHESIVE CURES

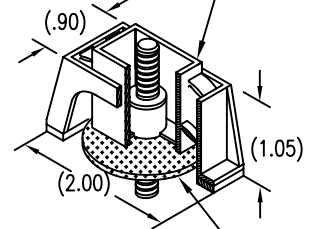

MOUNTING ADHESIVE APPLIED TO THIS SURFACE

MATERIAL AND FINISH DATA

CODE	STUD AND COLLAR MATL	SPEC	FINISH	SPEC
CR	302, 303, 304, OR A-286 CRES	AMS 5513, 5516, 5525, 5636, 5637, 5638, 5639, 5640, 5641, 5647, 5726, 5731, 5732, 5734, OR 5737	PASSIVATE	QQ-P-35
BC	COPPER	ASTM B170 C10100	SILVER PLATE	AMS 2410

CODE	BASEPLATE MATL
G	GLASS/EPOXY 250° F

CODE	INSULATOR MATL
P	PHENOLIC

ASSEMBLY METHOD OPTIONS

CODE	COLLAR TO STUD JOINT
-	THREADED
A	THREADED AND SOLDERED WITH TYPE SN 62 SOLDER PER QQ-S-571

EXAMPLE PART NUMBER

CB9047 G 4 BC 20 P 8 A 20-8

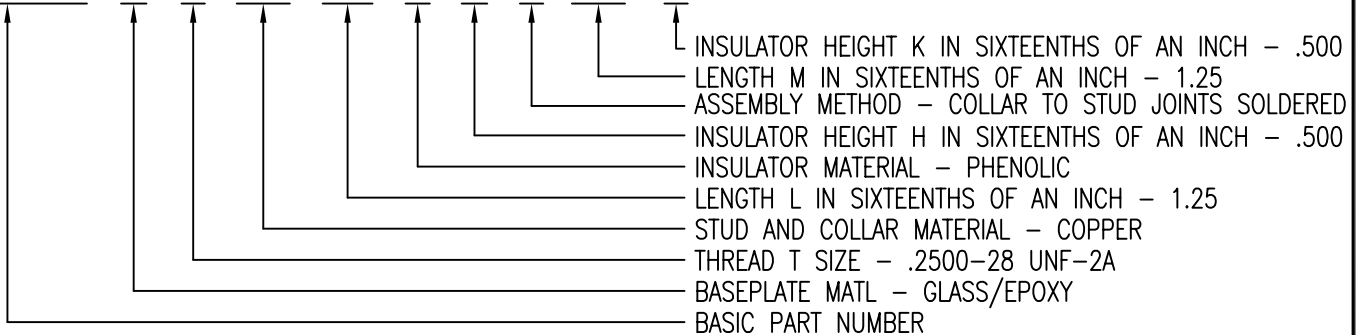

UNLESS OTHERWISE SPECIFIED, ALL DIMENSIONS ARE IN INCHES AND TOLERANCES ARE AS SHOWN BELOW. DIMENSIONAL TOLERANCES AND SYMBOLS PER ANSI Y14.5M-1982.

PROPRIETARY PARTS SHOWN IN THIS DRAWING ARE THE SUBJECT OF ISSUED UNITED STATES AND FOREIGN PATENTS AND PATENTS PENDING. UNAUTHORIZED REPRODUCTION AND/OR DISTRIBUTION OF THIS DRAWING IS SPECIFICALLY PROHIBITED.

GLICK BOND

CARSON CITY
NEVADA 89706

ANGLES	±1°	APPROVALS		DATE
		DRAWN	MGV	7FEB97
.XX	±.03	CHECKED	DAC	7FEB97
.XXX	±.010	RELEASED	CGH	7FEB97
.XXXX	±.001	REVISED	MGV	7FEB97

TITLE			
STUD, ELECTRICAL FEEDTHRU			
SIZE	CAGE CODE	DWG. NO.	REV.
A	66530	CB9047	7
SCALE	1/1	7FEB97	SHEET 1 OF 1