

TORX DRIVE RECESS  
PER NAS1800

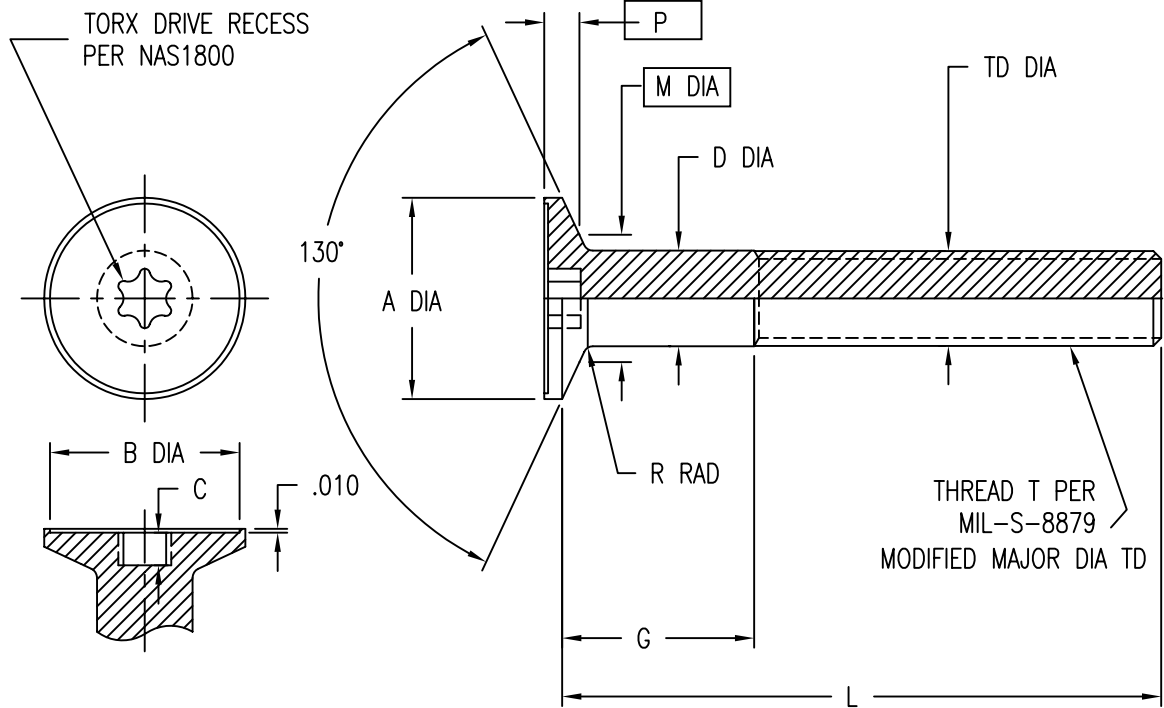

PART NUMBER	THREAD T	A	B	C	D	G	L	M	P	R	TD	TORX RECESS
CB9274-3	.1900-32 UNJF-3A	.404	.374	.075	.1895 .1885	.438	1.06	.2440	.0841	.030 .020	.1850	T-20
CB9274-4	.2500-28 UNJF-3A	.524	.494	.085	.2495 .2485	.500	1.56	.3314	.0917	.030 .020	.2450	T-20
CB9274-5	.3125-24 UNJF-3A	.616	.586	.090	.3120 .3110	.500	1.56	.4046	.0963	.040 .030	.3070	T-30
CB9274-6	.3750-24 UNJF-3A	.722	.692	.095	.3745 .3735	.500	1.56	.4853	.1020	.040 .030	.3690	T-40

MATERIAL: POLYETHERIMIDE THERMOPLASTIC  
FINISH: AS MOLDED

UNLESS OTHERWISE SPECIFIED, ALL DIMENSIONS ARE IN INCHES AND TOLERANCES ARE AS SHOWN BELOW. DIMENSIONAL TOLERANCES AND SYMBOLS PER ANSI Y14.5M-1982.

PROPRIETARY PARTS SHOWN IN THIS DRAWING ARE THE SUBJECT OF ISSUED UNITED STATES AND FOREIGN PATENTS AND PATENTS PENDING. UNAUTHORIZED REPRODUCTION AND/OR DISTRIBUTION OF THIS DRAWING IS SPECIFICALLY PROHIBITED.

**GLICK BOND**

CARSON CITY  
NEVADA 89706

		APPROVALS	DATE	TITLE			
ANGLES	±1°	DRAWN CGH	6DEC99	BOLT, 130° CSK RIMMED HEAD, PLASTIC			
.XX	±.03	CHECKED DAC	7DEC99	SIZE	CAGE CODE	DWG. NO.	REV.
.XXX	±.010	RELEASED CGH	7DEC99	A	66530	CB9274	2
.XXXX	±.001	REVISED CGH	6DEC99	SCALE	2/1 6DEC99		SHEET 1 OF 1