

STANDOFF STRAIGHT WITHIN .004 INCH PER INCH OF LENGTH.  
 PITCH DIA CONCENTRIC WITH BASE O.D. WITHIN .020 FIM.  
 PITCH DIA PERPENDICULAR TO BASE WITHIN ±1 DEG.

LENGTH L DATA (LENGTH L IN SIXTEENTHS OF AN INCH)

CODE	5	6	7	8	9	10	11	12	13	14	15	16	17	18	20	22	24
L	.312	.375	.437	.500	.562	.625	.687	.750	.812	.875	.937	1.000	1.062	1.125	1.250	1.375	1.500
D MIN	.218	.295	.400	.472													

STANDOFF MATERIAL AND FINISH DATA

CODE	MATERIAL	SPEC.	FINISH	SPEC.
A	2024 OR 6061	AMS-QQ-A-200, AMS-QQ-A-225, AMS-QQ-A-250	NONE	
AA	ALUMINUM		ANODIZE	MIL-A-8625
CR	302, 303, 304 OR A-286 CRES	AMS 5513, 5516, 5636, 5637, 5638, 5639, 5640, 5641, 5647 AMS 5525, 5726, 5731, 5732, 5734, 5737 (CHEMISTRY ONLY)	PASSIVATE	AMS-QQ-P-35
CRA	A-286 CRES	AMS 5525, 5726, 5731, 5732, 5734, 5737 (CHEMISTRY ONLY)	PASSIVATE	AMS-QQ-P-35
T	6AL-4V TITANIUM	AMS 4911, 4928, 4965, OR 4967	NONE	

THREAD T DATA

CODE	THREAD SIZE
06	.1380-32 UNC-3B
08	.1640-32 UNC-3B
3	.1900-32 UNF-3B

MS21209 OR NAS1130 INSERT.  
 INSERT INSTALLED PER MS33537.  
 DRI-FILM LUBE ON INSERT PER MIL-PRF-46010.  
 THREAD LOCK PER NASM25027.  
 STANDOFF ACCOMMODATES AS8879 UNJ THREAD SCREW.

BASEPLATE MATERIAL

CODE	MATERIAL
C	CARBON/EPOXY, 350°F CURE
E	GLASS/EPOXY, 350°F CURE
G	GLASS/EPOXY, 250°F CURE
U	GLASS/PEI, 30% GLASS
UC	CARBON/PEI, 30% CARBON
V	GLASS/PEI, 40% GLASS
VC	CARBON/PEI, 40% CARBON
W	GLASS/PEI, 30% GLASS, LOW HEAT RELEASE
WC	CARBON/PEI, 30% CARBON, LOW HEAT RELEASE

EXAMPLE PART NUMBER

CB4001 G 3 CRA 12 H P 750

OPTIONAL TRIMMED BASE - .750  
 OPTIONAL MIL-PRF-85582 EPOXY PRIMER ON BASEPLATE  
 OPTIONAL INSPECTION HOLE  
 STANDOFF LENGTH L - .750  
 STANDOFF MATERIAL - A-286 CRES  
 THREAD SIZE T - .1900-32 UNF-3B  
 BASEPLATE MATERIAL - GLASS/EPOXY, 250°F CURE  
 BASIC PART NUMBER

UNLESS OTHERWISE SPECIFIED, ALL DIMENSIONS ARE IN INCHES AND TOLERANCES ARE AS SHOWN BELOW. DIMENSIONAL TOLERANCES AND SYMBOLS PER ANSI Y14.5M-1982.

PROPRIETARY PARTS SHOWN IN THIS DRAWING ARE THE SUBJECT OF ISSUED UNITED STATES AND FOREIGN PATENTS AND PATENTS PENDING. UNAUTHORIZED REPRODUCTION AND/OR DISTRIBUTION OF THIS DRAWING IS SPECIFICALLY PROHIBITED.

**GLICK BOND**

CARSON CITY  
 NEVADA 89706

CAD CB4001-1

APPROVALS	DATE
DRAWN <i>DAC</i>	2JAN05
CHECKED <i>DAC/John</i>	2JAN05
RELEASED <i>CGH</i>	2JAN05
REVISED <i>DAC</i>	2JAN05

TITLE			
STANDOFF, LOCKING THREAD, COMPOSITE BASE			
SIZE	CAGE CODE	DWG. NO.	REV.
A	66530	CB4001	22
SCALE	1/1	2JAN05	SHEET 1 OF 2

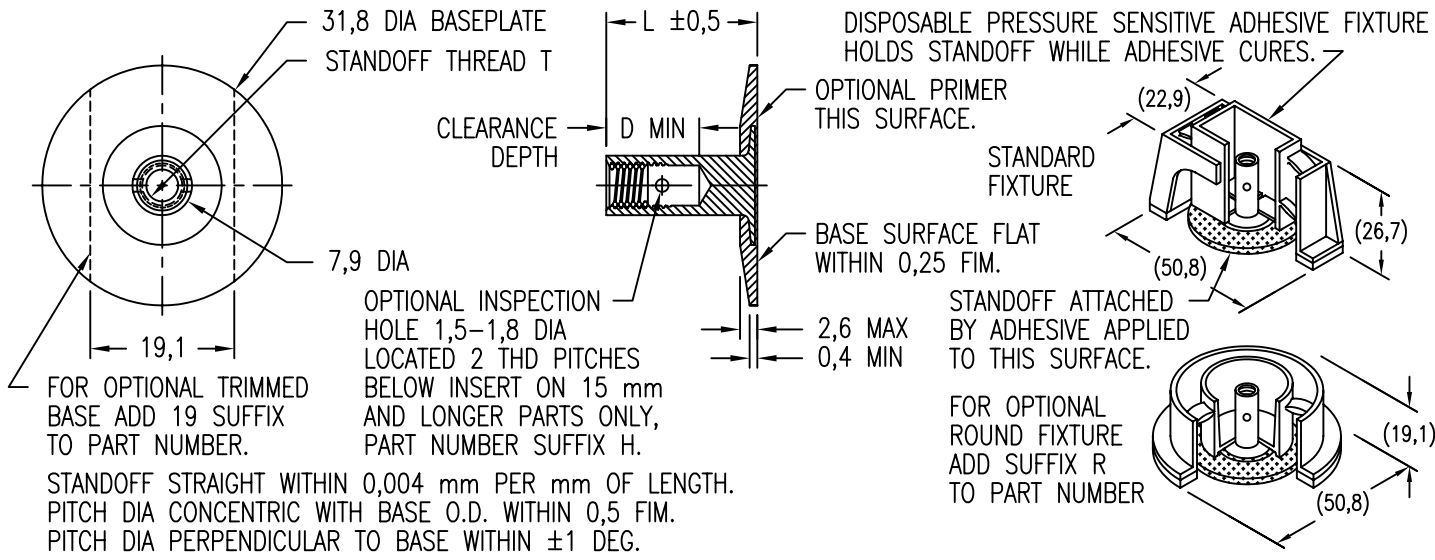

FOR OPTIONAL TRIMMED BASE ADD 19 SUFFIX TO PART NUMBER.

OPTIONAL INSPECTION HOLE 1.5-1.8 DIA LOCATED 2 THD PITCHES BELOW INSERT ON 15 mm AND LONGER PARTS ONLY, PART NUMBER SUFFIX H.

STANDOFF STRAIGHT WITHIN 0,004 mm PER mm OF LENGTH.  
 PITCH DIA CONCENTRIC WITH BASE O.D. WITHIN 0,5 FIM.  
 PITCH DIA PERPENDICULAR TO BASE WITHIN ±1 DEG.

STANDOFF MATERIAL AND FINISH DATA

CODE	MATERIAL	SPEC.	FINISH	SPEC.
A	2024 OR 6061	AMS-QQ-A-200, AMS-QQ-A-225, AMS-QQ-A-250	NONE	
AA	ALUMINUM		ANODIZE	MIL-A-8625
CR	302, 303, 304 OR A-286 CRES	AMS 5513, 5516, 5636, 5637, 5638, 5639, 5640, 5641, 5647 AMS 5525, 5726, 5731, 5732, 5734, 5737 (CHEMISTRY ONLY)	PASSIVATE	AMS-QQ-P-35
CRA	A-286 CRES	AMS 5525, 5726, 5731, 5732, 5734, 5737 (CHEMISTRY ONLY)	PASSIVATE	AMS-QQ-P-35
T	6AL-4V TITANIUM	AMS 4911, 4928, 4965, OR 4967	NONE	

LENGTH L DATA (LENGTH L IN MILLIMETERS)

CODE	10M	12M	15M	20M	25M	30M	35M
L	10	12	15	20	25	30	35
D MIN	7,50		12,30				

BASEPLATE MATERIAL

CODE	MATERIAL
C	CARBON/EPOXY, 177°C CURE
E	GLASS/EPOXY, 177°C CURE
G	GLASS/EPOXY, 121°C CURE
U	GLASS/PEI, 30% GLASS
UC	CARBON/PEI, 30% CARBON
V	GLASS/PEI, 40% GLASS
VC	CARBON/PEI, 40% CARBON
W	GLASS/PEI, 30% GLASS, LOW HEAT RELEASE
WC	CARBON/PEI, 30% CARBON, LOW HEAT RELEASE

THREAD T DATA

CODE	THREAD SIZE
3M	M3 X 0,5 4H5H
4M	M4 X 0,7 4H6H
5M	M5 X 0,8 4H6H

MA3330 OR EQUIVALENT INSERT.  
 INSERT INSTALLED PER MA1567.  
 DRI-FILM LUBE PER MIL-PRF-46010.  
 THREAD LOCK PER ISO2320.  
 STANDOFF ACCOMMODATES ISO5855 MJ THREAD SCREW.

EXAMPLE PART NUMBER

CB4001 G 5M CRA 20M H P 19

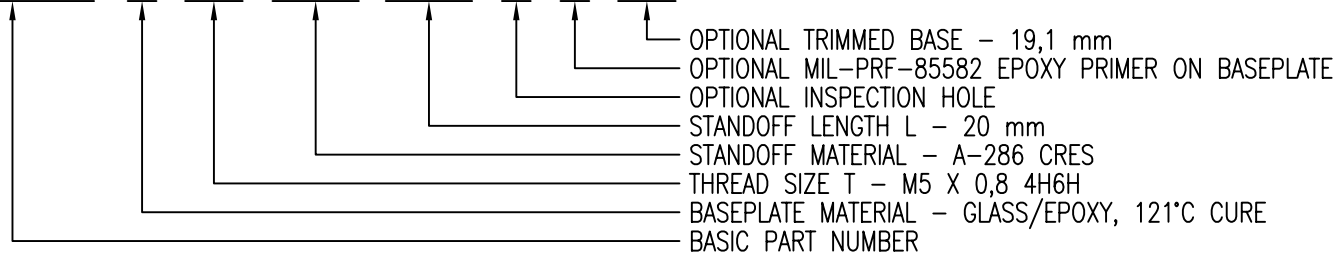

UNLESS OTHERWISE SPECIFIED, ALL DIMENSIONS ARE IN INCHES AND TOLERANCES ARE AS SHOWN BELOW. DIMENSIONAL TOLERANCES AND SYMBOLS PER ANSI Y14.5M-1982.

PROPRIETARY PARTS SHOWN IN THIS DRAWING ARE THE SUBJECT OF ISSUED UNITED STATES AND FOREIGN PATENTS AND PATENTS PENDING. UNAUTHORIZED REPRODUCTION AND/OR DISTRIBUTION OF THIS DRAWING IS SPECIFICALLY PROHIBITED.

**GLICK BOND** CARSON CITY NEVADA 89706

CAD CB4001-2 METRIC DIMENSIONS		APPROVALS	DATE	TITLE			
ANGLES	±1°	DRAWN	DAC	STANDOFF, LOCKING THREAD, COMPOSITE BASE			
.XX	±0,8	CHECKED	DAC	SIZE	CAGE CODE	DWG. NO.	REV.
.XXX	±0,25	RELEASED	CGH	A	66530	CB4001 (METRIC)	22
		REVISED	DAC	SCALE	1/1	2JAN05	SHEET 2 OF 2